

63-67 A.C. Inner Firewall BASIC 20 Piece Seal Kit

Includes 11 die cut rubber seals, 1 rubber seal with PSA (= Pressure Sensitive Adhesive), 4 felt seals, 2 putty seals & 2 poly foam seals. Every seal required to restore the inner A/C firewall boxes, the ducts & the deflector is included! Plus staple wire & semi-tubular Aluminum rivets.

Includes parts **ABCDEFGHIJKLMNO**.

See individual lists below. 8846121 42.50 Kt

DELUXE 20 Piece Seal Kit

Includes parts **ABCDEFGHIJKLMNO**.

With PSA mounted on **FGHI** 8846122 57.50 Kt

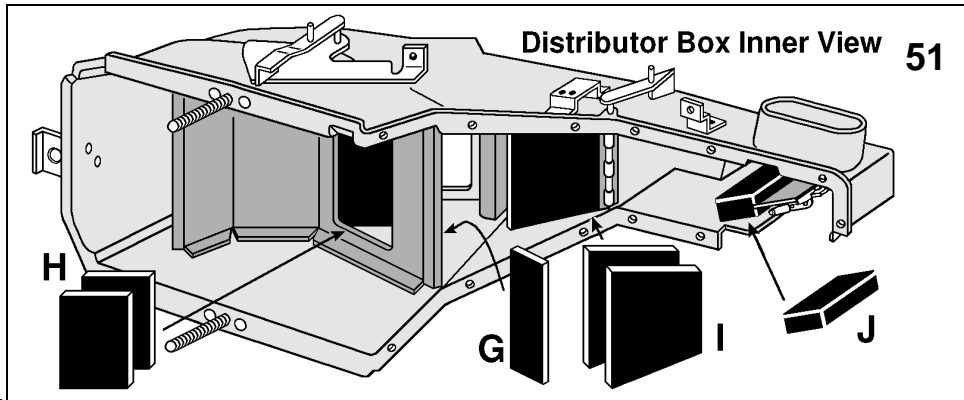

Distributor Box Inner View 51

Individual Inner A.C. Seals

A Inner Firewall Seal	8846160	15.75
B Heater Core Putty Seal	8846161	4.35
C Cold Air Duct Strip Seal	8846162	2.50
D Cold Air Duct Distrib Seal	8846163	4.35
E Distrib Box Rear Cover Seal	8846164	7.40
F Distrib Duct Rear Seal	8846165	5.50
G Distrib Duct Front Seal	8846166	3.30
H Hot Air Door Seals Pair	8846167	4.40
I Cold Air Door Seals Pair	8846168	6.30
J Defroster Door Seal	8846169	3.30
K Vent Door Seal	8846174	4.50
L Upper Center Duct Seal	8846170	4.40
M Lower Center Duct Seal	8846173	7.40
N RH Duct Clamp Seal	8846172	3.30
O Deflector Ball Seal 4 Piece Set	8846171	6.00

Underdash Box, Ducts & Parts

P 63-67 Underdash Duct Flex Hose 3 Piece Set Pre-cut OEM Black Cloth Covered Hoses with Spiral Wire Support for the Center & LH Ducts	9218140	25.00
63-67 Underdash LH Duct Hose Clamps discontinued		
NOS White Tower Style 2 reqd	4166960	22.50
63-67 LH & RH Duct Mounting 12 Piece Screw Kit mounts Ducts to Brackets & to Body	8848158	3.50

? 63-66 and 67 AC Ducts have **Fixed Deflector Balls** and **Do Not** have the Shut Off Valves or Chrome Knob

Q 63-66 LH AC Duct ?	9222410	192.50
Q 67 LH AC Duct ?	9222412	192.50
63-67 LH Duct Bracket to Kick Panel	9222402	15.00
63-67 LH Duct Bracket to Steering Column	9222404	24.00
R 63-66 RH AC Duct ?	9222414	192.50
R 67 RH AC Duct ?	9222416	192.50
67 RH AC Duct Mounting Bracket	9222430	24.00
Q+R 63-66 LH & RH Duct Set ?	9222438	349.00
Q+R 67 LH & RH Duct Set ?	9222440	359.00
S 63-67 Lower Center Duct	9222418	109.00
63-67 Defroster Upper Duct	9222420	97.25
63-67 Defroster Duct 4 Piece Mount Kit	8848160	0.00
T 63-67 RH Duct Mounting Clamp	9222406	27.95
63-67 RH Duct Clamp Mount Screw	8848162	1.85
U 63-67 Upper Center Dash Outlet Duct		
Does Not Include Deflector	9222428	192.50
63-67 Deflector 4 Piece Mounting Kit includes 2 Washers & 2 Hairpin Style Clips.	8848164	3.00
63-67 Lower "Y" Duct mounts to bottom of the Distributor Box to distribute heat	9222422	128.75
63-67 "Y" Duct 2 Piece Mounting Kit	8848166	2.50
V 63-67 Rear Cold Air Duct Cover	9222432	42.00

W 63-67 Rear Cold Air Distribution Duct mounts to the front side of the distributor box. 9222436 110.00

AC Control Cable Mounts

63-67 Control Cable Mounting Nut 4 Piece Set Mounts the Push-Pull Cables to the Pins on the AC Box Control Levers.	9220405	2.75
63-67 Dash Cable 7" Tie Strap Binds Together the AC Control Cables behind the dash, just behind the Clock.	2259212	3.00

How to Repair Broken A.C.-Heater Cables

63-67 BOWEN "PUSH PULL" CABLE REPAIR KIT Includes 4 Foot Piece of proper Diameter Temp resistant Cable and Detailed Instructions. Requires Brazing, Grinding and Filing. 8852204 12.00

Below are lengths required on some of these cables
 63-67 AC Heater & Defroster Control 30"
 63-67 AC Heater & AC Temp Control 23 1/2"
 63-67 AC Air Blower Switch Inlet Control 38 3/4"
 63-67 AC Air Vent Control 41 3/4"

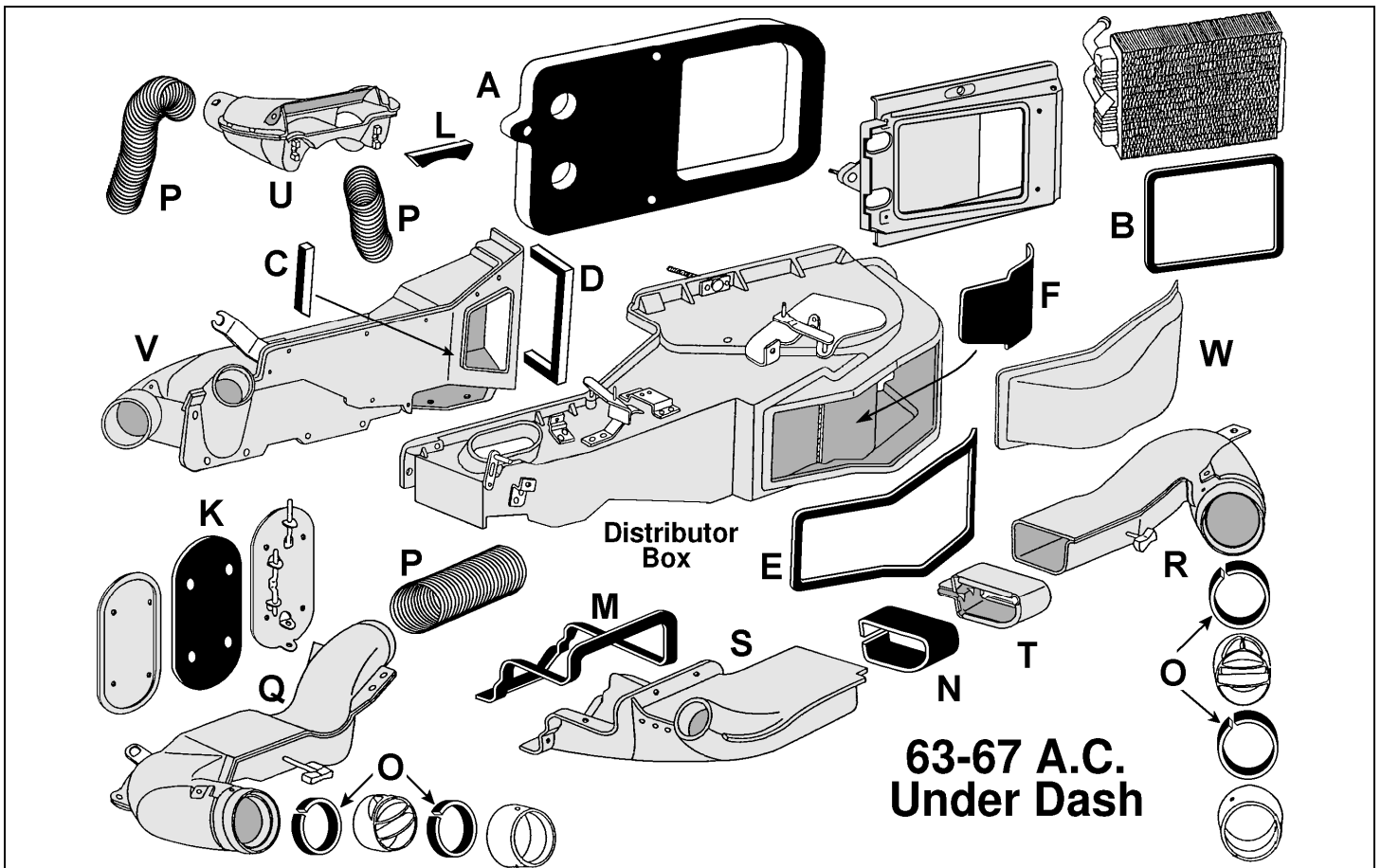

63-67 A.C.
Under Dash