

56-62 WINDSHIELD WASHER HOSE KITS

- These kits include...
- ✓ Complete set of hose with raised ribs
 - ✓ Schematic Diagram
 - ✓ T-pipe Connector

Pre-cut to Factory lengths – no guesses here No Zip Blem Product Surprises Either

Early 53 Washer Hose Kit to VIN 180 approximately use a foot pump & a jar	1014705	12.00
Late 53 from VIN 181 - Early 54 to VIN 548 Washer Hose Kit to use a vacuum pump & a jar	1014706	12.00
Late 54 from VIN 549 - Early 55 to VIN 400 Washer Hose Kit to use a foot pump & a jar	1014707	12.00
Late 55 Washer Hose Kit from VIN 401 approximately Kit to use a foot pump & a bag	1014708	12.00
56 Washer Hose Kit	1014720	22.00
57 Washer Hose Kit	1014721	22.00
58-62 Washer Hose Kit without F.I.	1014722	24.00
58-61 Washer Hose Kit with F.I.	1014723	24.00
62 Washer Hose Kit with F.I.	1014724	24.00

Below are Replacement Blem equivalent Hose Kits

58-62 Washer Hose Kit without F.I.	1014570	19.50
58-61 Washer Hose Kit with F.I.	1014571	19.50
62 Washer Hose Kit with F.I.	1014572	19.50

Red, Orange & Black 58-62 Washer Hose Kits

According to the NCRS some 58-62's had washer hoses with color striped hoses. These kits are the same as the above kits with the addition of Red and Orange stripes as required. Documentation of these color coded design hoses can be found in the NCRS RESTORER Magazine Vol. 16, No. 3, Page 20.

58-62 Colored Washer Kit without F.I.	1014702	30.00
58-61 Colored Washer Hose Kit with F.I.	1014703	30.00
62 Colored Washer Hose Kit with F.I.	1014704	30.00

Washer Hose Grommets

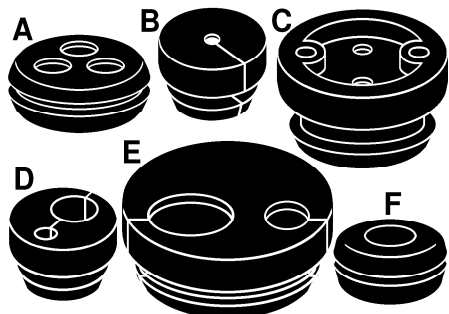

A 53-55 3 Port Grommet	1014709	Disc
B 56-57 1 Port Grommet	9760110	3.50
C 58-62 2 Port Grommet	1014725	9.75
D 58-62 4 Port Grommet	9760112	9.00
E 63-67 Wiper Motor Firewall Grommet Not replacement urethane	1014649	9.80
F 63-76 1 Port Grommet Pair	1014739	3.50

Washer Fluid Reservoirs

56 Washer Bag (no Cap)	1014732	0.00
57-62 Washer Bottom Jar Only Creamy off white plastic.	1014733	39.50
57-62 Washer Jar Bracket 16 Piece Mounting Kit Includes 4 pan head machine screws, 4 flat & 4 star washers & 4 nuts. Does 1 car.	1014501	3.00
58-62 Washer Bottle Lid Only molded plastic without pump assembly. Select from...		
58-Early 59 Light Blue Lid	1014792	44.50
Late 59-62 Light Gray Lid	1014793	44.50

Washer Hose Tie Straps

Keep wiper hoses out of harms way with these authentic design & material tie straps.

Tie Strap Style	Amount Required		
G 53-57 Oval End Brass	5	2259100	3.00
H 58-60 Square End Brass	5	2259101	3.00
I 58-62 White Plastic	1	2259301	3.00
J 61-62 Aluminum Strap	6	2259300	3.00
K 63-64 White Plastic	5	2259201	3.00
L 65-67 Black Plastic	5	2259202	3.00

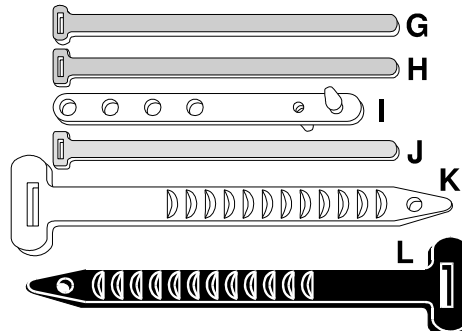

58-62 Vacuum Tank & Valve

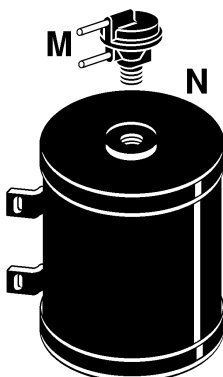

M+N Vacuum Tank & Valve Authentic design select From 2 designs

58-E61 Tank & Valve with mtg. holes 1014715 145.00

L61-62 Tank & Valve with mtg. studs 1014715 145.00

58-E61 Vacuum Tank to Fender 6 Piece Mount Kit Includes 2 pan head machine screws, 2 flat washers & 2 star washers. Does 1 car. 1014502 3.00

Washer Squirter Nozzles

O+P+Q 53-62 Washer Squirter Nozzles made in the USA with rounded corners Pair 1014709 39.95

O+P+Q = 53-62 Washer Squirter Nozzles made in Asia Complete nozzle housing with screw in squirter, mounting gasket & even including the authentic steel nuts! As high as \$16. each. Why pay more? 1014714 12.25

P 53-62 Washer Nozzle Mounting Gaskets Pair Neoprene sheet rubber. 1014716 1.95

Q 53-62 Washer Nozzle Mounting Nuts Pair Flat sheet metal style with Zinc plating; not hex replmt. 1014717 9.00

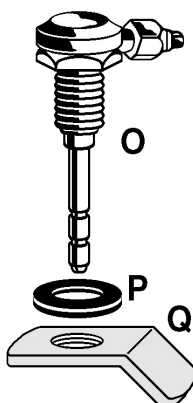

Wiper Cable Mounting

R 55-62 Washer Activating Cable Mount

Includes die cast retainer, washer & slotted mounting screw. Attaches foot pedal cable or coordinator cable to the wiper motor. 1014485 22.50

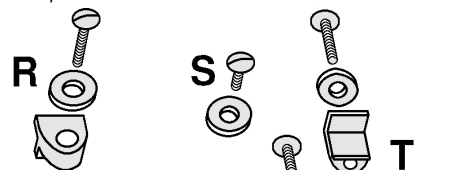

S 55-60 Wiper Switch Cable Retainer

Includes washer & slotted head screw. Not used on 57-60 with windshield washers. 1014484 1.80

T 55-56 Wiper Motor Cable Mounting Kit

Includes Zinc pedestal with 3 slotted head mounting screws, plus parts "R" and "S". This kit attaches both the wiper switch cable and the foot pedal cable to the wiper motor. 1014486 47.50

U 56-60 Wiper Switch Cable Mounting Plate

Includes die cast Zinc plate with 2 slotted head screws plus above part "S". Use on all models with or without windshield washers. (Note: Order part "V" if you need a complete set-up.) 1014489 40.00

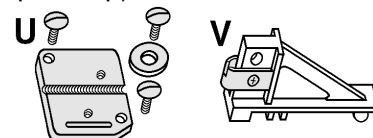

V 57-62 Wiper Motor Plastic Slide

Molded plastic with u-shaped metal retainer plus mounting screw & nut. Connects the wiper cable to the motor on models without windshield washers & connects the washer coordinator adapter on models with windshield washers. 1014633 7.50

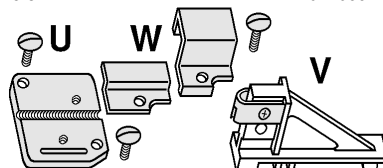

W 57 Wiper Motor Cable Clamp Set

Includes die cast Zinc retainer, plated steel plate & a slotted head mounting screw. Connects both the wiper switch cable & foot pedal cable to the motor. (Note: Order parts "U" & "V" if you require a complete set-up.) 1014487 0.00

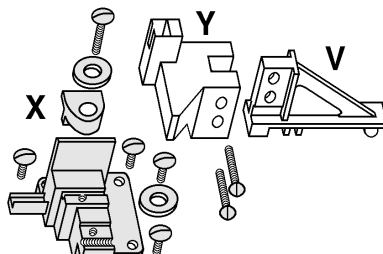

X 58-62 Washer Coordinator Mounting Bracket Kit

Includes die cast Zinc pedestal with 3 slotted head mounting screws, plus above parts "R" and "S". This kit attaches both the coordinator cable & the wiper switch cable to the motor. Only used with windshield washers. 1014488 0.00

Y 58-62 Washer Coordinator Adapter

Molded plastic with 2 slotted head screws to attach to the wiper motor slide. Only used with windshield washers. 1014482 12.50

On models with windshield washers order parts "V", "X" & "Y" if you require a complete set-up (minus the coordinator).