

**Exhaust Hardware**

**French Locks** our factory design 4 piece sets will not interfere with ignition shield. Use only on the manifold end bolts. To prevent loose bolts, bend tabs over after run-in and re-torque.

55-56 265 1x4 French Locks	3604100	20.50
<b>A</b> 56 265 2x4 French Locks or		
57-63 283 327 French Locks	3604101	15.00
<b>B</b> 64-65 327 French Locks	3604102	15.00
<b>C</b> 66-79 327 350 French Locks	3604103	19.25
<b>D</b> 65-74 396 427 454 French Locks	3604104	15.00
80 305 French Locks	3604105	15.00
<b>E</b> 56-80 Exhaust Bolt 8 Piece Washer Set		
Prevents bolts from bottoming out in the block. Cadmium Plated Steel. These are only used on the end bolts.		
Does 1 car.	3275100	9.35

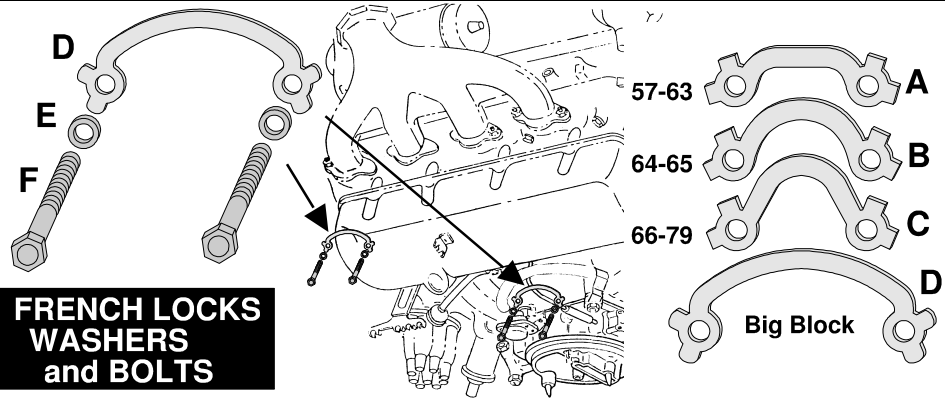

**F Exhaust Manifold Bolts & Studs**

*Quantity Required*

55 V8 Manifold Bolt	12	3275104	6.75
56-79 Small Block End Bolt	8	3275105	2.75
56-79 Small Block Center Bolt	4	3275106	4.10
64-76 Small Block AC Rhl Bolt	1	3275108	6.00
64-76 Small Block AC Rhl Stud	1	3275109	17.50
65-74 Big Block Bolt	16	3275110	4.25
66-74 Big Block with PS Stud	1	3275112	3.70
66-74 Big Block AC Stud	2	3275114	10.00

**Exhaust Manifold Bolt & Stud Sets**

62-63 Small Block 12 piece Set	3275081	27.00
64-76 Small Block 12 piece Set with AC	3275082	29.00
64-65 Small Block 12 piece Set with FI	3275081	27.00
56-79 Small Block 12 piece Set exc above	3275080	23.00
65-74 Big Block 16 piece Set exc AC or PS	3275083	28.00
65-74 Big Block 16 piece Set+ PS exc AC	3275084	29.00
66-74 Big Block 16 piece Set+ AC exc PS	3275085	30.00
66-74 Big Block 16 piece Set+ AC+ PS	3275086	33.00

**Lower Exhaust Manifold Studs**

**55-78 Exhaust Manifold Lower Stud & Nuts**

With 3 long & 3 short studs & 6 mfg nuts. Does 1 car.

Set with **Brass Nuts**

3613210 8.95

Set with **Lock Nuts**

3613212 9.50

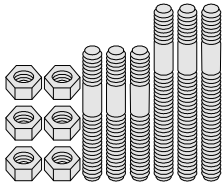

**USA Small Block Exhaust Manifold**

57-80 Exhaust Manifold Gasket Set	3601204	16.00
58-63 <b>LH 2"</b> GM #3749965	3601102	188.00
58-65 <b>RH 2"</b> GM #3750556	3601104	229.00
63-65 <b>RH 2"</b> GM #3817806	3601110	295.00
64-67 <b>LH 2"</b> GM #3846559	3601108	275.00
62-63 <b>LH 2 1/2"</b> GM #3797901	3601112	279.95
64-65 <b>LH 2 1/2"</b> GM #3846563	3601114	279.95
62-65 <b>RH 2 1/2"</b> GM #3814970	3601116	279.95
66-71 <b>LH 2"</b> GM #3846559	3601124	249.00
66-71 <b>LH 2"</b> GM #342243	3601126	279.55
72-80 350 <b>LH or RH</b> Exhaust Manifold includes A.I.R. hobs	3601128	279.55

**USA Big Block Exhaust Manifold**

65-74 Exhaust Manifold Gasket Set	3601205	19.45
66-69 <b>LH</b> no smog hobs GM	3601150	369.00
66-69 <b>RH</b> no smog hobs GM	3601151	349.00
66-69 <b>LH</b> with smog hobs Re pro	3601154	365.00
66-74 <b>RH</b> with smog hobs Re pro	3601152	365.00
70-74 <b>LH</b> with smog hobs GM	3601160	429.00
70-74 <b>LH</b> with smog hobs Re pro	3601106	369.00

**Intake Manifolds Gasket Set**

69-72 350 or 76 350 or		
78-81 350 Intake Gasket Set <b>GM</b>	3601206	20.00
73 or 75 350 Intake Gasket Set <b>GM</b>	3601208	18.35
74 350 Intake Gasket Set <b>GM</b>	3601210	20.50

65 69 425, 430, 435, 450 H P and,		
71 LS-6 425 H P Intake Gasket Set <b>GM</b>	3601212	25.00
66 69 390 H P and,		
70-72 454 Intake Gasket Set <b>GM</b>	3601214	20.80
73-74 454 Intake Gasket Set <b>GM</b>	3601216	19.50

**Exhaust Packing & Extension**

Packing a "donut" like gasket that fits in manifold outlet		
57-74 Packing <b>2"</b> 2 reqd	3605330	4.00
62-74 Packing <b>2 1/2"</b> 2 reqd.	3605331	6.60
Extensions are short pipes that fit into manifold outlet		
55-74 Extension <b>2"</b>	3609201	9.50
62-81 Extension <b>2 1/2"</b>	3609202	12.50

**Heat Riser, Gasket & Flange,**

Heat Risers only used on RH side, except F.I. ? Note: Ins tall with the weight towards the rear.

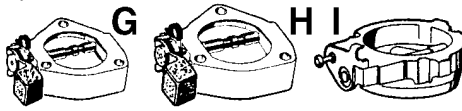

<b>G</b> 57-74 Heat Riser <b>2"</b> GM	3605305	53.35
57-74 Heat Riser <b>2"</b> repro	3605334	39.50
58-61 FI Heat Riser Spacer <b>2"</b> GM	3605304	50.00
<b>H</b> 62-74 Heat Riser <b>2 1/2"</b> GM	3605306	57.70
<b>H</b> 62-74 Heat Riser <b>2 1/2"</b> repro	3605335	39.50
57-74 Heat Riser Anti Rattle Spring	3605302	Disc
<b>I</b> 75-79 Heat Riser	3605333	84.95
Heat Riser Gasket between heat risers and the manifold.		
57-74 Heat Riser Gasket <b>2"</b>	3605325	6.00
62-74 Heat Riser Gasket <b>2 1/2"</b>	3605326	4.85
55-75 Flanges <b>2"</b>	3605310	10.00
62-75 Flanges <b>2 1/2"</b>	3605311	14.50

**Exhaust Bezels**

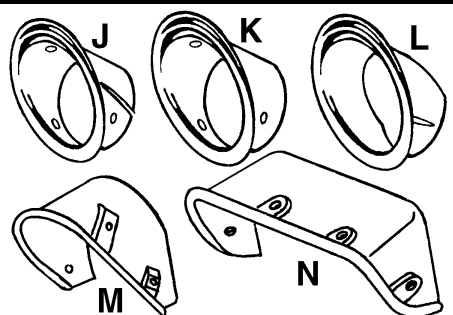

Exhaust Bezels fit in the opening of the Rear Fiberglass Panel where the Exhaust Tips exit.

<b>J</b> 63 Stainless Exhaust Bezel Pair	3705201	98.95
63-65 6 Piece Screw Mounting Kit	3705200	2.75
63-65 6 Piece U-Nut Mounting Kit	3705199	2.75
<b>K</b> 64-65 Stainless Exhaust Bezel Pair	3705202	125.00
<b>L</b> 66-67 Chrome Plated Exhaust Bezel		
<b>LH</b> Bezel in GM box	3705203	85.00
<b>RH</b> Bezel in NOS in GM box	3705204	85.00
<b>LH &amp; RH</b> Bezel Pair <b>Repro</b>	3705213	96.85
66-67 6 Piece Nut Mounting Kit	3705196	2.75

<b>M</b> 68-69 Chrome <b>LH</b> Bezel <b>NOS</b>	3705207	65.00
68-69 Chrome <b>RH</b> Bezel <b>NOS</b>	3705208	Disc
16 Piece Screw & U-Nut Mounting Kit	3705195	2.75
<b>M</b> 68-69 <b>LH &amp; RH</b> Bezel Pair Stainless	3705216	84.95
<b>N</b> 70-73 <b>LH</b> Bezel Chrome <b>Repro</b>	3705310	49.50
70-73 <b>RH</b> Bezel Chrome <b>Repro</b>	3705311	49.50
<b>N</b> 70-73 <b>LH</b> Bezel Chrome <b>NOS</b>	3705209	75.00
70-73 <b>RH</b> Bezel Chrome <b>NOS</b>	3705210	75.00
<b>N</b> 70-73 <b>LH &amp; RH</b> Bezel Pair Stainless	3705214	83.50
16 Piece Screw & U-Nut Mounting Kit	3705195	4.95

**Stainless Exhaust Tips**

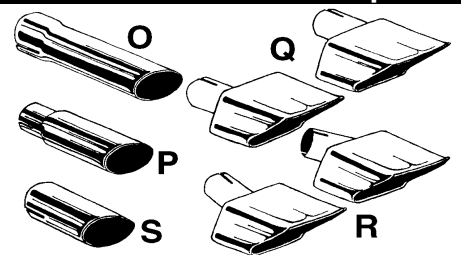

<b>O</b> 63-67 <b>SS</b> Tip <b>USA</b> 2 reqd.	3705301	19.75
63-67 <b>SS</b> Tip <b>Import</b> 2 reqd.	3705306	18.00
<b>P</b> 68-69 <b>SS</b> Tip <b>USA</b> 2 reqd.	3705302	20.70
68-69 <b>SS</b> Tip <b>Import</b> 2 reqd.	3705307	19.00
<b>Q</b> 70-72 <b>SS</b> Tip <b>USA</b> Pair	3705303	54.95
70-72 <b>SS</b> Tip <b>Import</b> Pair	3705308	51.95
<b>R</b> 73 <b>SS</b> Tips <b>USA</b> Pair	3705304	57.35
74-82 <b>SS</b> Tip <b>Import</b> Pair	3705309	32.95
<b>S</b> 74-82 <b>SS</b> Tips <b>USA</b> Pair	3705305	35.95

**Exhaust Pipe Heat Shields**

? Includes Mounting Straps & Screws Prevent Heat Transfer to Cockpit

63-64 <b>2"</b> Heat Shield Pair	3608208	39.75
65-67 <b>2"</b> Heat Shield Pair	3608209	41.75
<b>T</b> 63 <b>2 1/2"</b> Heat Shield Pair	3608202	44.75
<b>U</b> 64-65 <b>2 1/2"</b> Heat Shield Pair	3608204	44.75
<b>V</b> 66-67 <b>2 1/2"</b> Heat Shield Pair	3608206	44.75
63-67 Heat Shield Mounting Strap <b>NOS</b> steel includes the factory stamped logo	3608200	15.00
63 Rear Exhaust Heat Shield mount base on the exhaust tips to help prevent blistering of the exhaust filler panel paint. Zinc plated. 2 reqd.	3608201	23.75

